

# Register and Save!

Offer includes  
**50% off**  
your next order  
of assorted  
tips + tip  
storage case.



## Save over \$50!

Register at [Waterpik.com/Registration](https://www.waterpik.com/Registration) to receive exclusive discount code.

## We'd Love to Hear from You!



Connect with Us  
@Waterpik



Call: 1-800-525-2774  
[www.waterpik.com](https://www.waterpik.com)

## Waterpik® 14 Day Challenge App

Make water flossing a habit! Try our new mobile App for the best water flossing experience



**waterpik**  
completecare

# Congratulations!

You are now on your way  
to better oral health!

### ✓ Register and Save

Register your product at [waterpik.com/registration](https://www.waterpik.com/registration) to receive over **\$50** in savings (includes **50%** off your next order of assorted tips + tip storage case).

### ✓ Write a Review

Creating innovative Waterpik® products that inspire better oral health is our passion. We invite you to leave a review by sharing your thoughts on the Waterpik® Complete Care Water Flosser on [waterpik.com](https://www.waterpik.com) or the retailer's website.

### ✓ We're Here to Help

We hope you are loving your new Waterpik® Complete Care Water Flosser. If for any reason you are not satisfied or have any product questions, please contact our fast and friendly Customer Service Team based in Fort Collins, Colorado. Waterpik® Complete Care Water Flosser is backed by a 2-year manufacturer's warranty.

Call: 1-800-525-2774  
Monday-Friday  
7 am - 5 pm MST



Chat or E-mail  
[service@waterpik.com](mailto:service@waterpik.com)



**Quick Start  
Guide Inside!**



# Quick Start Guide

## PRIMING UNIT (FIRST TIME USE ONLY)

- 1 Fill reservoir with warm water and replace it firmly on the base.



- 2 Insert tip firmly until it clicks into place.

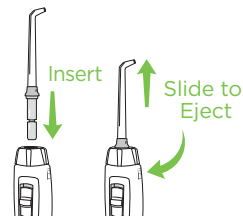

- 3 Turn pressure to high, point tip into sink. Turn power ON and water switches ON. Leave on until water flows, then turn power and water OFF.

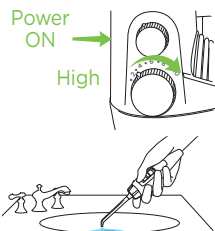

## NEED HELP?

Visit [Waterpik.com/WelcomeCC](http://Waterpik.com/WelcomeCC)

To watch a How To Video and find additional product support.

**Call Us! 1-800-525-2774**

## WATER FLOSS

- 4 Turn pressure to low. With water switch in OFF position, place tip in mouth. Turn power ON. Turn water switch ON.

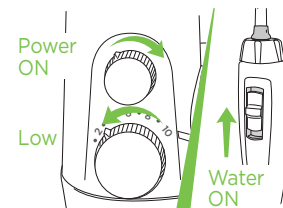

- 5 Close lips enough to prevent splashing, while still allowing water to flow from mouth into the sink. Increase pressure to your liking.

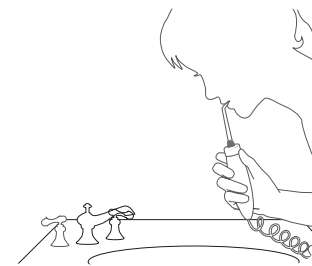

- 6 Aim water at the gumline at a 90 degree angle. Follow the gumline and pause briefly between teeth.

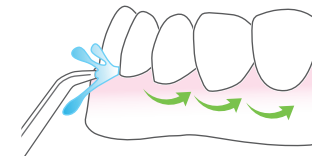

**TO AVOID MESS: PLACE THE TIP IN YOUR MOUTH BEFORE TURNING WATER ON.**